

WASHINGTON COUNTY PARKS RULES & REGULATIONS

AN ORDINANCE PRESERVING RULES & REGULATIONS FOR PRESERVING PUBLIC PROPERTY AND TO PROMOTE AND PRESERVE PUBLIC HEALTH, SAFETY AND WELFARE IN WASHINGTON COUNTY DEPARTMENT OF PARKS & RECREATION AND, PRESCRIBING PENALTIES FOR THE VIOLATIONS OF SUCH REGULATIONS.

- Section 1. **PARK HOURS** -- The Parks shall be open from sunrise to sunset unless otherwise posted. No person without an official permit or special permission, other than authorized employees, shall be, remain, or loiter in the parks, under any circumstances during the hours the parks are closed.
- Section 2. **PARK PROTECTION** -- No person shall injure, destroy, deface, remove, cut or damage any of the trees, plants, turf, wildlife structures, equipment or fixtures therein, or any property of Washington County, located within the Parks. Any person inflicting damage upon public property shall make repair to the County for said damage, which said repair may be collected as other debts are collectible at law.
- Section 3. **REFUSE DISPOSAL** -- No person shall dispose of any waste, rubbish, or garbage except in receptacles designated for such purposes, and such disposal shall be limited to materials accumulated during the use of a Washington County Park.
- Section 4. **FIRES** -- No person shall set or maintain any fire except in stoves, grills, fireplaces and areas designated by Park Authority.
- Section 5. **GLASS CONTAINERS** -- The use of glass containers is restricted to picnic tables in order to prevent injury or damage to persons or property by broken glass.
- Section 6. **WEAPONS AND EXPLOSIVES** -- Discharge of any firearms, bows and arrows, or any type of weapon or explosive is prohibited unless specific areas are designated for their use. Nothing in this provision shall regulate firearms and ammunition.
- Section 7. **BEHAVIOR** -- No person shall conduct herself or himself in any manner which causes harm to the health, safety, morals or general welfare of any person within the Park. Creating excessive noise, gambling, drunkenness, disorderly or indecent conduct and profane and offensive language are hereby prohibited. The use or possession of narcotic drugs is prohibited.
- Section 8. **DOMESTIC ANIMALS AND PETS** -- No domestic animals or pets are permitted in the park except on a leash or halter nor are such domestic animals or pets permitted to run or roam unattended nor to disturb persons or wildlife. Horseback riding is permitted only on and in designated trails and areas.
- Section 9. **SOLICITING** -- No person or persons shall post any sign, solicit, peddle or offer any articles for sale or service for hire within the Park or set up therein any stand or booth for such purposes without a permit from the Director of the Department of Parks & Recreation.
- Section 10. **GROUP MEETINGS** -- No meetings and assemblies (20 people or more) shall take place in the Park without written permission.
- Section 11. **CAMPING** -- No camping is permitted in the park unless areas are specifically designated and an official permit is obtained.
- Section 12. **SWIMMING** -- Swimming is permitted only in designated areas. The use of swimming areas will be controlled by posted regulations.
- Section 13. **BOATING** -- No vehicles are permitted on the boat launching ramps unless they are being used for launching or removing boats. The docking and control of boats will be governed by posted regulations. The size of motors used on Cross Creek Lake shall be limited to 10HP or less. Exception to horsepower limitations include boats authorized by the Parks Department to be used for park administration, police, fish and game enforcement, search and rescue, safety patrol and demonstration purposes. Prohibited watercraft include any boats propelled by air propellers, seaplanes, unseaworthy craft, surfboards, ski jets any equipment which is not constructed for the primary purpose of transportation on the water, inflatable devices except those which are longer than seven feet and have more than one separate buoyancy chamber. Float tubes specifically designed for the purpose of fishing are permitted. A float tube is a device constructed to provide stable flotation and a level ride to a single angler in a manner that minimizes the possibility of a capsizes. The float tube shall consist of a bladder system made of heavy gauge rubber of rubber impregnated support fabric and covered with a durable fabric shell, which provides a seat for the user and two leg holes. A secondary bladder in the form of a backrest or similar component shall be included with a float tube to provide additional emergency flotation. Individuals operating float tubes must wear an approved Coast Guard PFD at all times. Sailboats are limited to 17 feet in length. All boating regulation of the US Coast Guard and the Pennsylvania Fish Commission shall apply to Cross Creek Lake. All people fishing at Cross Creek Lake must have a valid Pennsylvania Fishing license in their possession. A boat launching permit is required for Cross Creek and Ten Mile Creek Parks.
- Section 14. **ALCOHOLIC BEVERAGES** -- Beer is the only alcoholic beverage permitted in the parks and is restricted to specified areas by permit only. No alcoholic beverage may be possessed or consumed by any minor.
- Section 15. **PARK FACILITIES** -- All park facilities shall be used only for their intended purposes. It is prohibited to move picnic tables or any other type of park property.
- Section 16. **MOTOR VEHICLES** -- The operation of licensed automobiles and trucks shall be confined to roads open to traffic and designated parking areas. All other types of motor vehicles including, but not limited to cycles, snowmobiles, all terrain vehicles and quads, are prohibited unless areas are designated for their use. Creating excessive noise or operating in a reckless manner or in excess of 15 MPH or as posted is prohibited. The Pennsylvania Vehicle Code, Act of 1976, P.L. 162, 1 of 2 No. 81, section 1, as amended, Title 75 P.S., is hereby declared to be in effect in all County parks on all roads therein, with like effect as though set forth herein in full, and the traffic rules and regulations set forth herein are in addition to and supplement the Vehicle Code.
- Section 17. **PENALTIES** -- Any person who shall violate any of the rules and regulations contained in this Ordinance shall, upon summary conviction thereof, before a Magistrate of Washington County, be sentenced to pay a fine of not more than Six Hundred (\$600.00) Dollars and costs of prosecution for each and every offense or to undergo imprisonment in the County Jail for not more than ten (10) days.
- Section 18. **ENFORCEMENT** -- The rules and regulations of this Ordinance shall be enforced by the Washington County Department of Parks and Recreation, their Police Officers or employees thereof, the Sheriff of Washington County and any Police Officer of this Commonwealth or any political subdivision thereof.

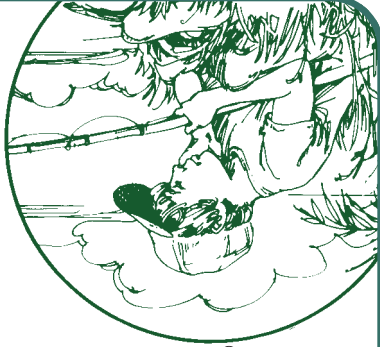

Ten Mile Creek County Park

Washington County Department of Parks & Recreation

724-228-6867

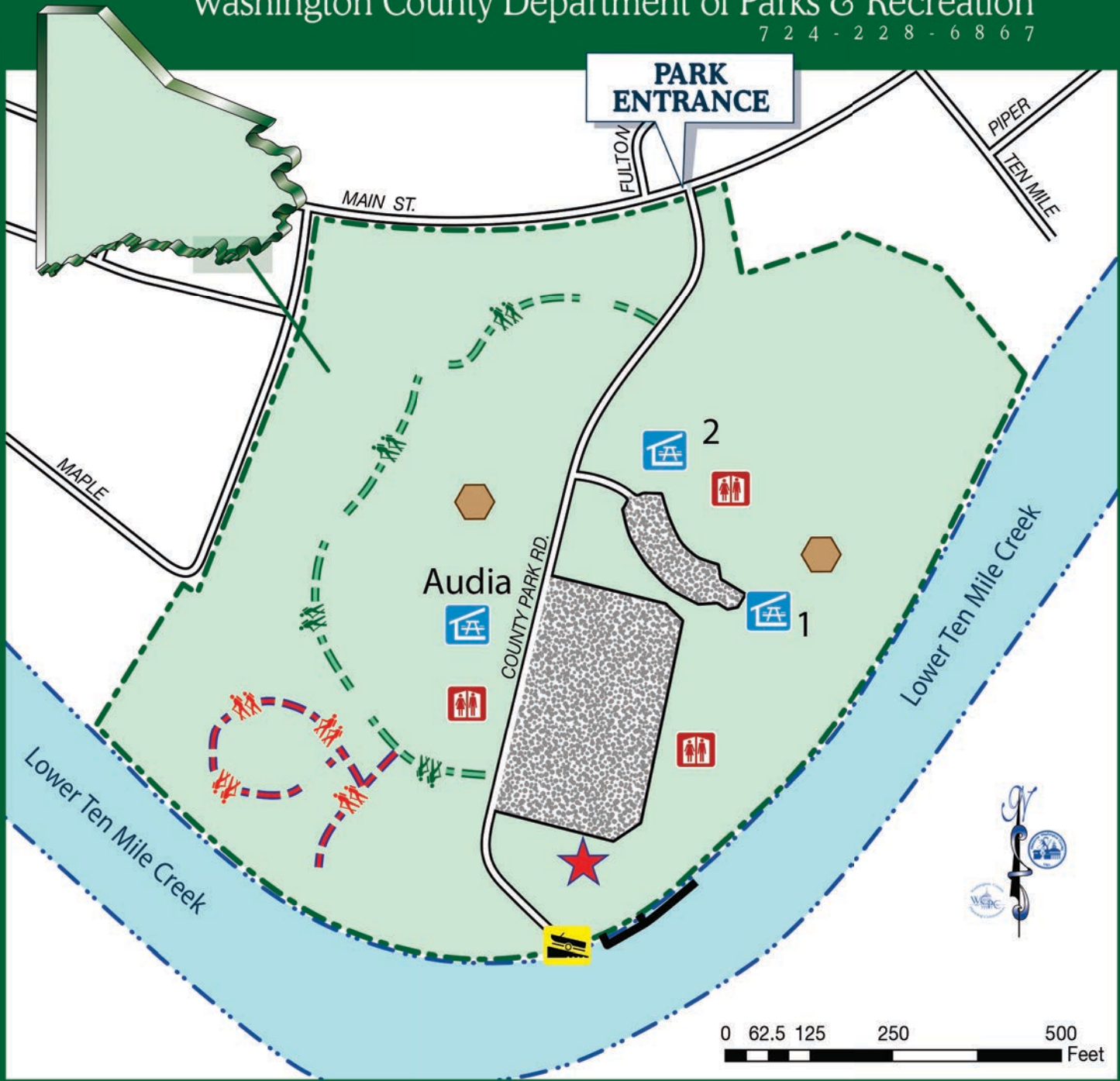

LEGEND

- Park Boundary
- Streets
- Parking Lots
- Shelters
- Restrooms
- Park Office
- Playground
- Boat Launch
- Park Trail
- Beaver Trail
- Boat Dock

Location Map

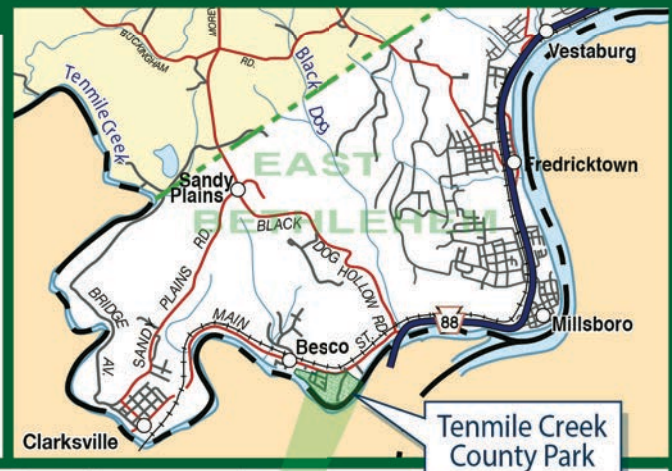

Diana Irely Vaughan
Chair

Larry Maggi
Vice Chair

Nick Sherman

Provided as a Public Service
for your information by
The Washington County Board
of Commissioners



Prepared and Published by
The Washington County
Department of Parks & Recreation
and the
Washington County
Planning Commission

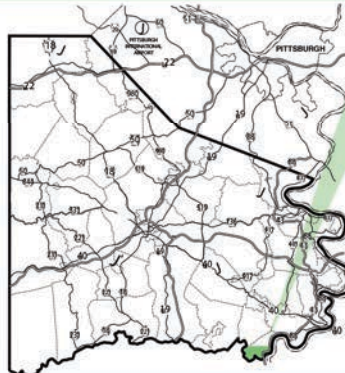

100 West Beau Street, Suite 705
Washington, PA 15301
Phone: 724-228-6867
Fax: 724-250-4603